

\*\*\*\*\* CAL. 1L/M/N/SXX MOV'T PART LIST \*\*\*\*\*  
 ORIGINAL PARTS, MADE IN JAPAN  
 "MIYOTA" GILT PLATED FLAT MOVEMENT COLLECTION

PART NAME	1L22	1L32	1L02	1L12	1L15	1L50	1M02	1M12	1M15	1M50	1N12	1L40	1L45	1S12	1S02
6X8 PLAIN 2HANDS	6X8 PLAIN 3HANDS	6X8 D+D 3HANDS	6X8 DATE 3 HANDS	6X8 DATE 2HANDS	6X8 DATE BIG D	10 1/2 D+D 3HANDS	10 1/2 DATE 3HANDS	10 1/2 DATE 2HANDS	10 1/2 DATE BIG D	8 3/4 DATE 3HANDS	6X8 LADIES' 11 1/2 DATE WALL SECON	6X8 GENTS' 11 1/2 DATE 3HANDS	11 1/2 DATE 3HANDS	11 1/2 D+D 3HANDS	
BATTERY	280-730	280-340									280-730	280-340			
BATTERY CONNECTOR	231-368														
BATTERY INSULATOR	230-220														
CALENDAR CORRECTOR INT. WHEEL	NIL	NIL	087-184			087-194	087-184			087-194	087-184	NIL	NIL	087-184	
CALENDAR CORRECTOR LEVER	NIL	NIL	116-112			116-118	116-112			116-118	116-113	NIL	NIL	116-113	
CALENDAR CORRECTOR WHEEL	NIL	NIL	213-410			213-410				028-282	028-288	NIL	NIL	213-410	
CANNON PINION WITH DRV. WHEEL	028-287	028-281	028-282	028-288	028-292	028-282	028-288	028-288	028-292	028-282	028-288	028-306	028-306	028-286	028-313
CLUTCH WHEEL	064-790														
COIL UNIT	246-181						246-182								
DIAL GUARD	NIL	NIL	713-112			713-123	713-112			713-123	713-112	246-181		713-112	
DIAL DRIVING WHEEL	NIL	NIL	103-111			103-118	103-111			103-118	103-111			103-111	
DATE DIAL GUARD	NIL	NIL	293-102	293-103	293-103	293-113	293-102	293-103	293-103	293-113	293-103	NIL	NIL	293-103	
DATE DIAL 1 (DATE DISC FOR THE 1ST DIGIT)	NIL	NIL	108-870	108-E50	108-E50	108-C1X	108-E40	108-E60	108-E60	108-B9X	108-C50	NIL	NIL	108-C90	108-C80
DATE DIAL 2 (DATE DISC FOR THE 2ND DIGIT)	NIL	NIL				108-C2X				108-C0X					
DATE JUMPER	NIL	NIL	109-500			109-660	109-500			109-660	109-500			109-500	
DAY DIAL GIB	NIL	NIL	178-140			178-140				178-140					
DAY OF WEEK DIAL (WEEKDAY DISC)	NIL	NIL	308-548A			308-588A									178-140
DIAL GUARD RING	NIL	NIL	110-420	110-430	110-430	110-420									308-A100
DIAL WASHER	078-040											078-040			
ELECTRONIC CIRCUIT UNIT	279-A460	279-A450										279-A454			
FIFTH WHEEL AND PINION	084-700											084-750		084-700	
FOURTH WHEEL AND PINION	023-318	023-322	023-323	023-327	023-328	023-323	023-322	023-327	023-328	023-323	023-327	023-328	023-328	023-326	023-353
FOURTH WHEEL	075-446		075-454	075-455	075-455	075-454	075-455	075-455	075-455	075-454	075-455	075-467	075-467	075-455	075-509
INTERMEDIATE SECOND WHEEL(1)	NIL	NIL										087-195	087-195		
INTERMEDIATE SECOND WHEEL(2)	NIL	NIL											087-196		
MINUTE WHEEL AND PINION	072-121											072-126	072-126	072-121	
ROTOR	285-175											285-176			
SCREW	923-107														
SCREW (2)	923-112														
SCREW FOR DIAL GUARD(3)	NIL	NIL	929-510											929-510	
SCREW FOR DIAL GUARD *	NIL	NIL													
SETTING LEVER	067-194		067-173											067-173	
SETTING LEVER SPRING	077-135										077-136				
SETTING STEM	065-477		065-505								065-477			065-505	
SETTING WHEEL	076-640														
SMALL SECOND WHEEL	NIL	NIL													
SMALL SECOND WHEEL HOLDER	NIL	NIL												025-107	
SPACER FOR SETTING STEM	212-239		212-241											903-106	
STATOR	190-152													212-239	
THIRD WHEEL AND PINION	017-151	017-149													
TRAIN WHEEL BRIDGE	701-C550	701-C580													
YOKE	071-136		701-E120	701-C62	701-E15	701-E010	701-C660	701-C670	701-E25	701-E000	701-E17	701-E200			

\*\*\*TERMS & CONDITIONS\*\*\*

PRICE : FOB JAPAN IN JAPANESE YEN  
 PAYMENT : ADVANCE PAYMENT BY T/T OR BANKER'S CHECK  
 MINIMUM UNIT ORDER : 100PCS PER EACH EXCEPT \* MARK(=1,000PCS)  
 \*THE PRICES MAY BE CHANGED WITHOUT NOTICE AND SUBJECT TO RECONFIRMATION.

T/L/M/L/L\*\*  
 CITIZEN WATCH CO.,LTD./P.M.G.

# CAL.1LXX PAGE1

## DISASSEMBLY AND ASSEMBLY OF MODULE

Disassembly procedure: ① → ③②

Assembly procedure: ③② → ①

● Lubrication mark

Ⓐ : A-Lube oil

Ⓥ : V-Lube oil

Ⓕ : F-Lube oil

⊖ : CH-1 oil

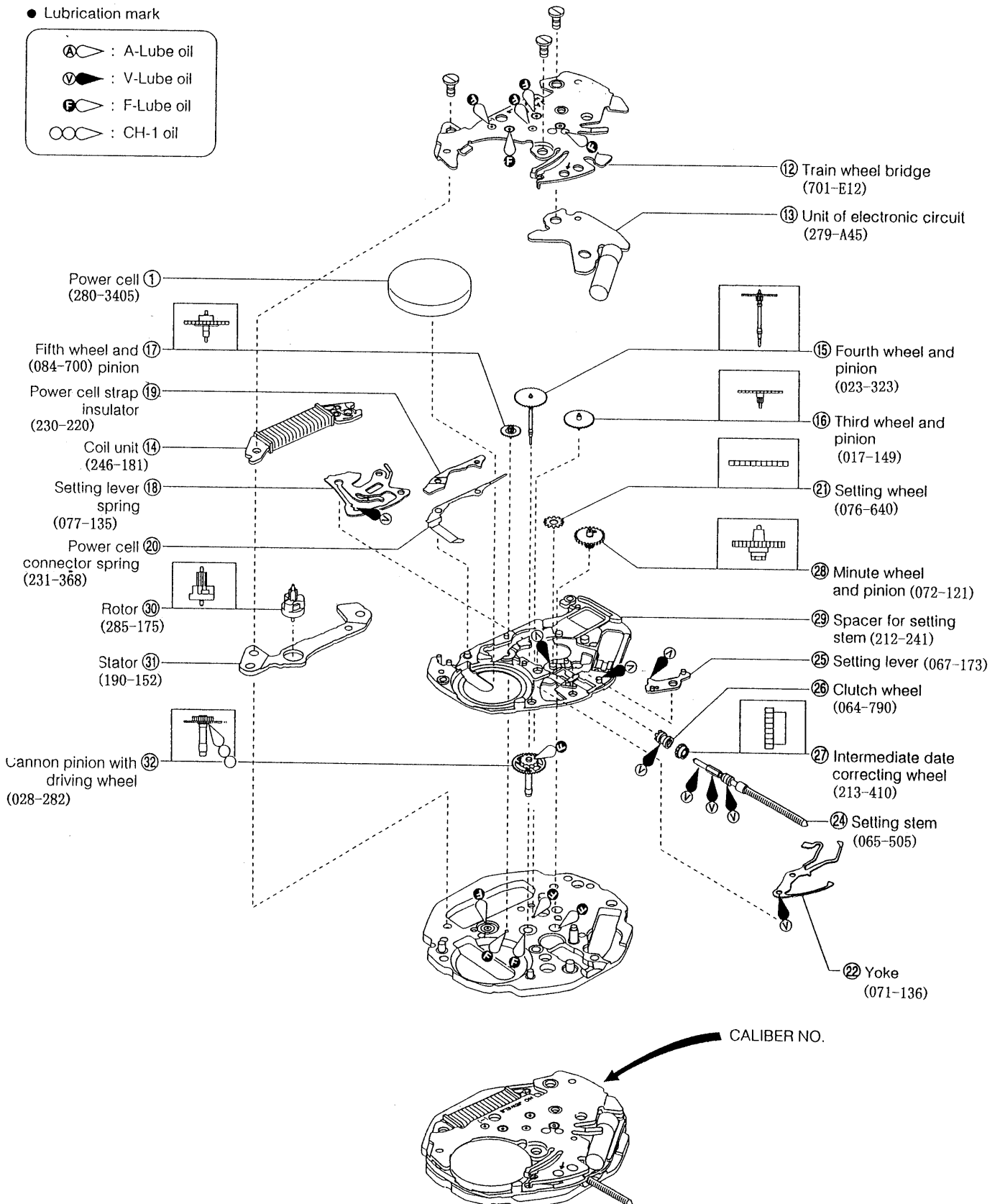

# CAL.1LXX PAGE2

